

# ORIA

CONDOMINIUMS

# B.1A.2

UNITÉS 323, 423, 523, 623, 723, 823, 923,  
1023, 1123, 1223, 1423, 1523, 1623

STUDIO — 461 PI<sup>2</sup>/SQ.FT

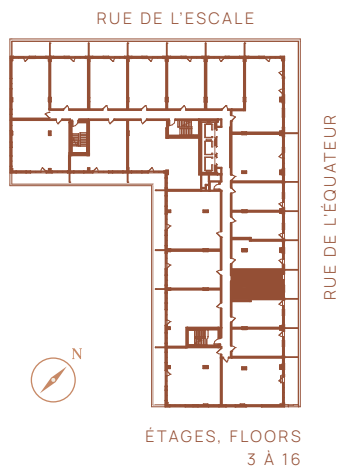
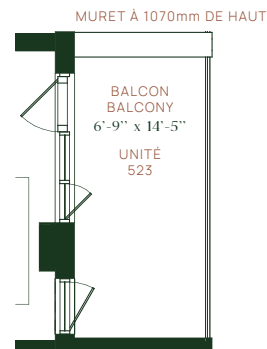
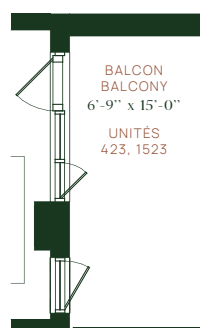
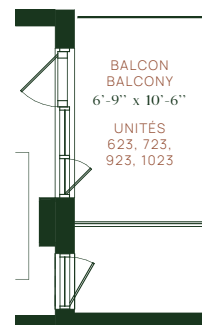
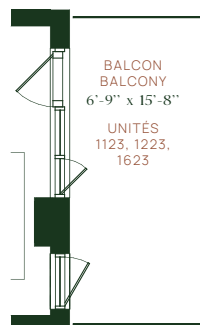
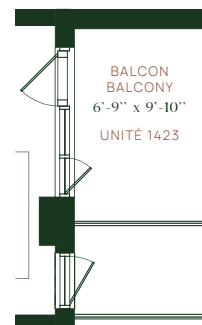
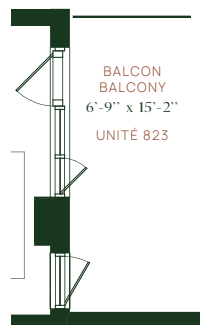
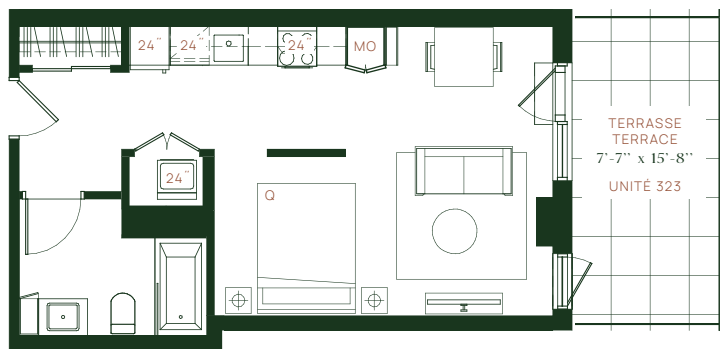

CUISINE  
KITCHEN  
13'-9" x 6'-4"

SÉJOUR  
LIVING ROOM  
SALLE À MANGER  
DINING ROOM  
8'-0" x 14'-10"

SALLE DE BAIN #1  
BATHROOM #1  
9'-7" x 7'-0"

CHAMBRE PRINCIPALE  
MASTER BEDROOM  
9'-4" x 8'-2"

BALCON  
BALCONY  
voir plan

Oria / 2020-11-05

Plans préliminaires sujets à changements. La superficie brute des logements n'inclut pas celle des balcons et/ou terrasses. La superficie et la dimension des plans de vente sont approximatives et peuvent varier. Preliminary plans subject to modifications. The unit area excludes the balcony and/or terraces. The areas are approximate and are subject to variation.

